

# ASSEMBLY INSTRUCTION

revision 02 / 1.2024



## WARNINGS

Before you begin assembling this sim racing cockpit add-on kit, please read all installation instructions and warnings thoroughly.

**FAILURE TO COMPLY WITH OR OBSERVE ALL ASSEMBLY, SAFETY AND OPERATION INSTRUCTIONS AND WARNINGS REGARDING THE USE OF THIS PRODUCT MAY RESULT IN SERIOUS BODILY INJURY.**

This product complies with the prescribed safety regulations. Inappropriate use may cause injury.

# A1-TX32

**Table of contents**

1 x 2pcs	Profile 80x40 L300mm
2 x 4pcs	Profile 80x40 L450mm
3 x 1pcs	Profile 80x40 L900mm
HS x 2 pairs	2 x Pair of brackets. 2 x HS-L, 2 x HS-R
L1 x 10pcs	L-Bracket H80mm
C1 x 8pcs	L-Bracket H80mm
VB x 3 pairs	Vesa Mounting bracket kit
V100 x 3pcs	100x100 VESA Support
V200 x 3pcs	Up to 200x200 VESA Support
U1 x 2pcs	U Mounting bracket

**6 Fasteners and tools**

SN x 36pcs	T-Nut M8 with ball insert
B1 x 26pcs	M8x16 countersunk
B2 x 4pcs	M8x20 countersunk
B5 x 6pcs	M8x16 din 912
B8 x 4pcs	M8x35 countersunk
B9 x 4pcs	M8x22 Shoulder bolt
B22 x 12pcs	M6x10 countersunk
B24 x 12pcs	M4x16 din 912
S1 x 4pcs	Sleeve
H3 x 1pcs	No.3 Hex Key
H4 x 1pcs	No.4 Hex Key
H5 x 1pcs	No.5 Hex Key
H6 x 1pcs	No.6 Hex Key

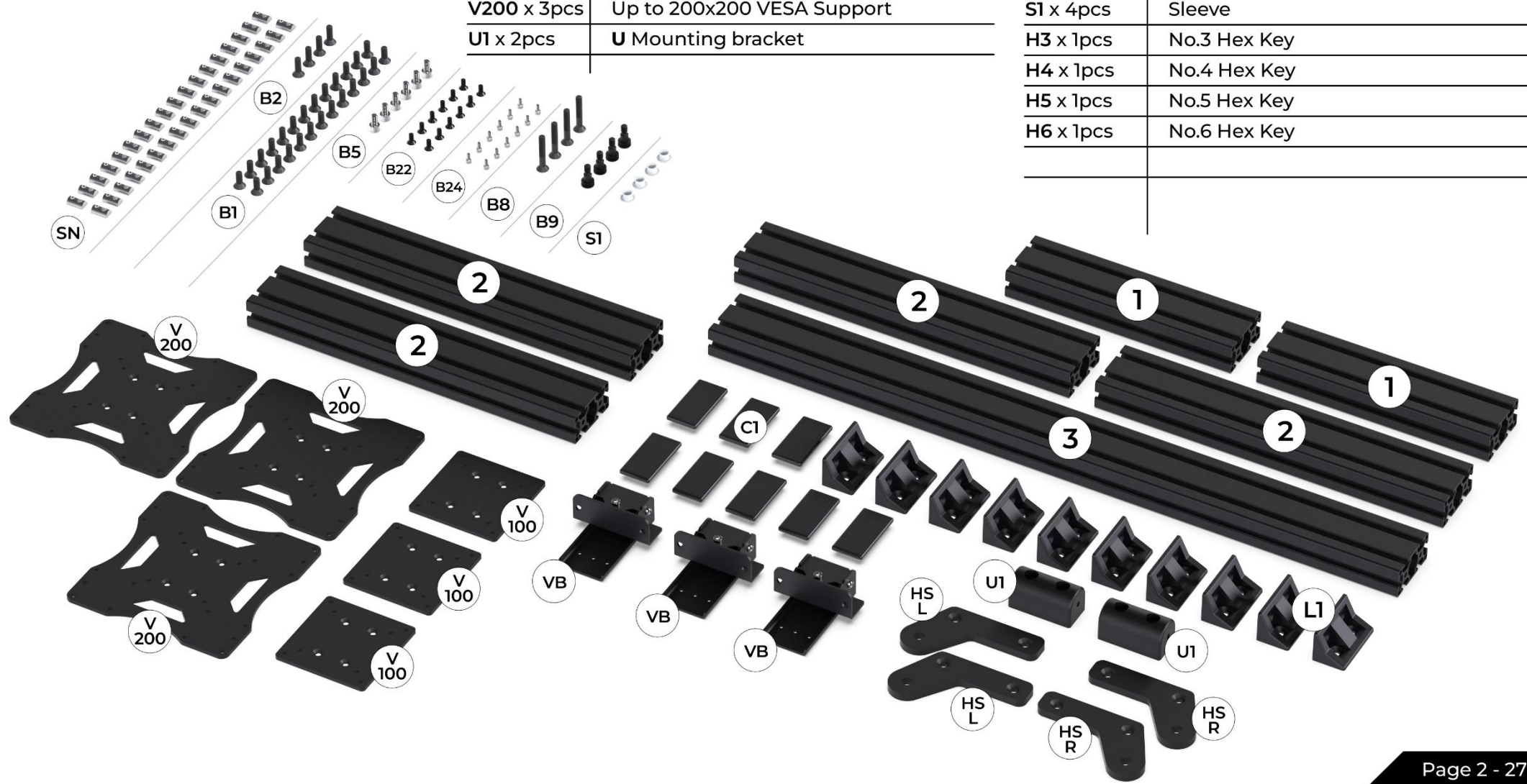

## Inserting T-Slot-Nuts:

All feature Roll in T-Nut with Ball Spring- M8 thread. It loads either from the profile ends or side. The nut can be easily rolled into the T-Slot. This helps where the profile ends are inaccessible (for example, installing accessories later on) The ball with a spring inside the nut, fixate it into place. It is self-aligning, so the thread will always be in the middle of the T-slot and will not fall down the T-Slot even if it's in vertical position when assembling the chassis (easy for the assembly).

### Roll into T-Slot

**Step 1:** Put the T-Nut (part SN) into the T-Slot channel in horizontal position.

**Step 2:** Rotate the nut. You can use the No.5 Hex Key to help wiggle the Slot-Nut in place.

**Step 3:** Set the T-Nut in place. The guide step positions the nut parallel and central within the slot, which makes it easier to move the nut and prevents from twisting during tightening. The spring-loaded ball prevents an unwanted movement of the nut in the slot, which is highly desirable on a bed with the T-slots in a vertical position.

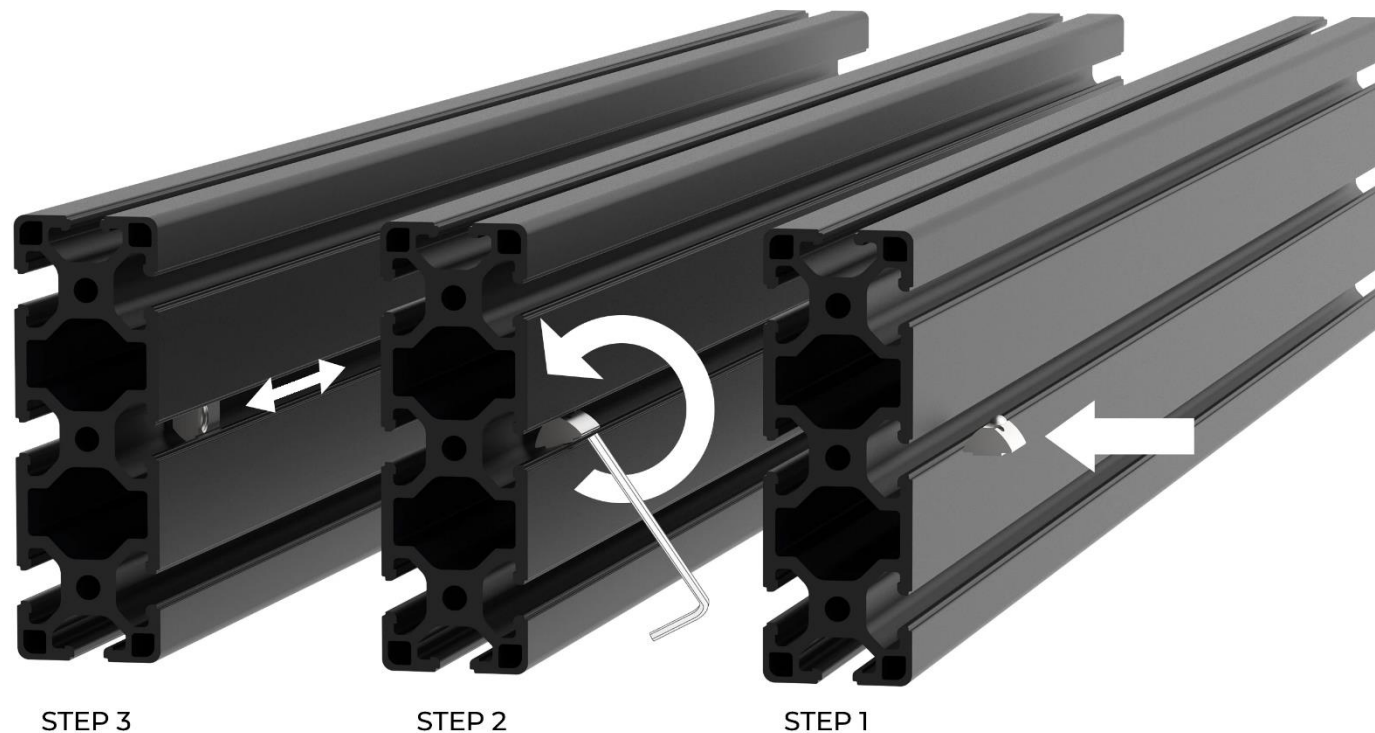



**Step 1.1, 1.2** Connect **L1** Bracket to assembly **1L** and **1R**. Use 4x **B1** M8 x 16 Countersunk to 4 x **SN** T-Nut. Screw by hand and do not tight. Align the brackets collinear. Just connect the bolts and T-Nuts with two turns with no tension. As per figure **1.1**  
Do this step for assembly **1L** and **1R**.

**Step 1.3** Insert 2 x **SN** T-Nut for assembly **1L** and **1R**.

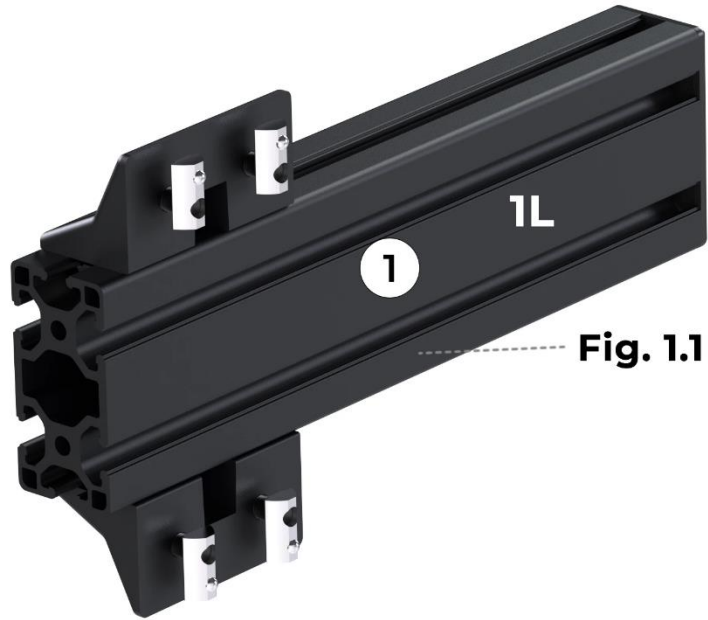

**Step 1.4** Install 1 x **C1** Plastic cap to **1L** and **1R** assembly rear end. Press by hand.

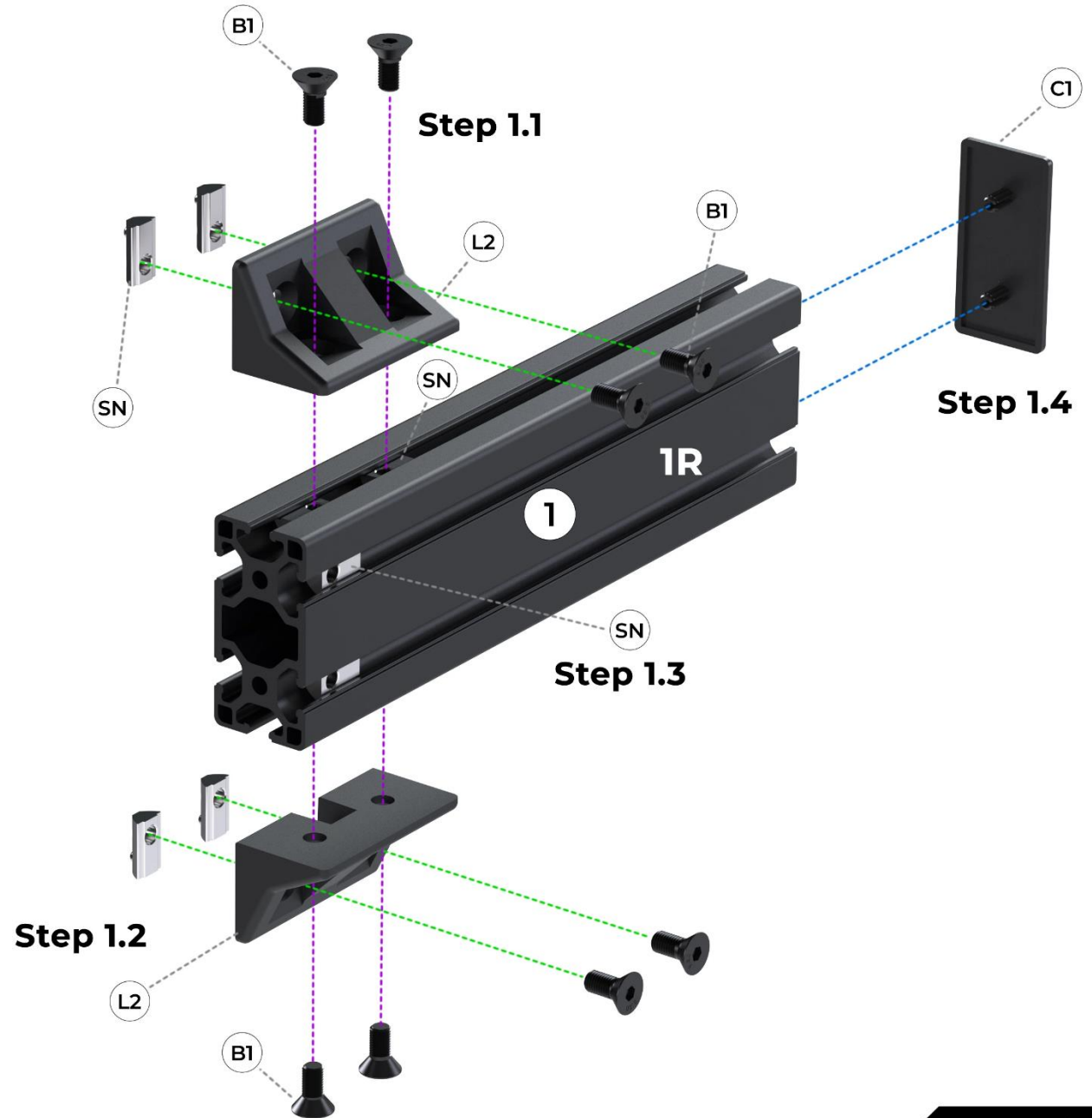



**Step 2.1** Install 2 x **L1** Brackets to assemblies **2L** and **2R**. Use 4 x **B1** - M8 x 16 Countersunk and 4 x **SN** T-Slot Nuts per profile. Use **No.5 Hex Key**.

**Hs** Height per chassis: **RSEAT AI-120 GT / AI-160GT** 120mm (4.7 inch), **RSEAT AI-120 Formula / AI-160 Formula** 240mm (9.4 inch)

**Step 2.2** Install 2 x **L1** Brackets to assemblies **2L** and **2R**. Use 4 x **B2** - M8 x 20 Countersunk per profile. Use **No.5 Hex Key**.

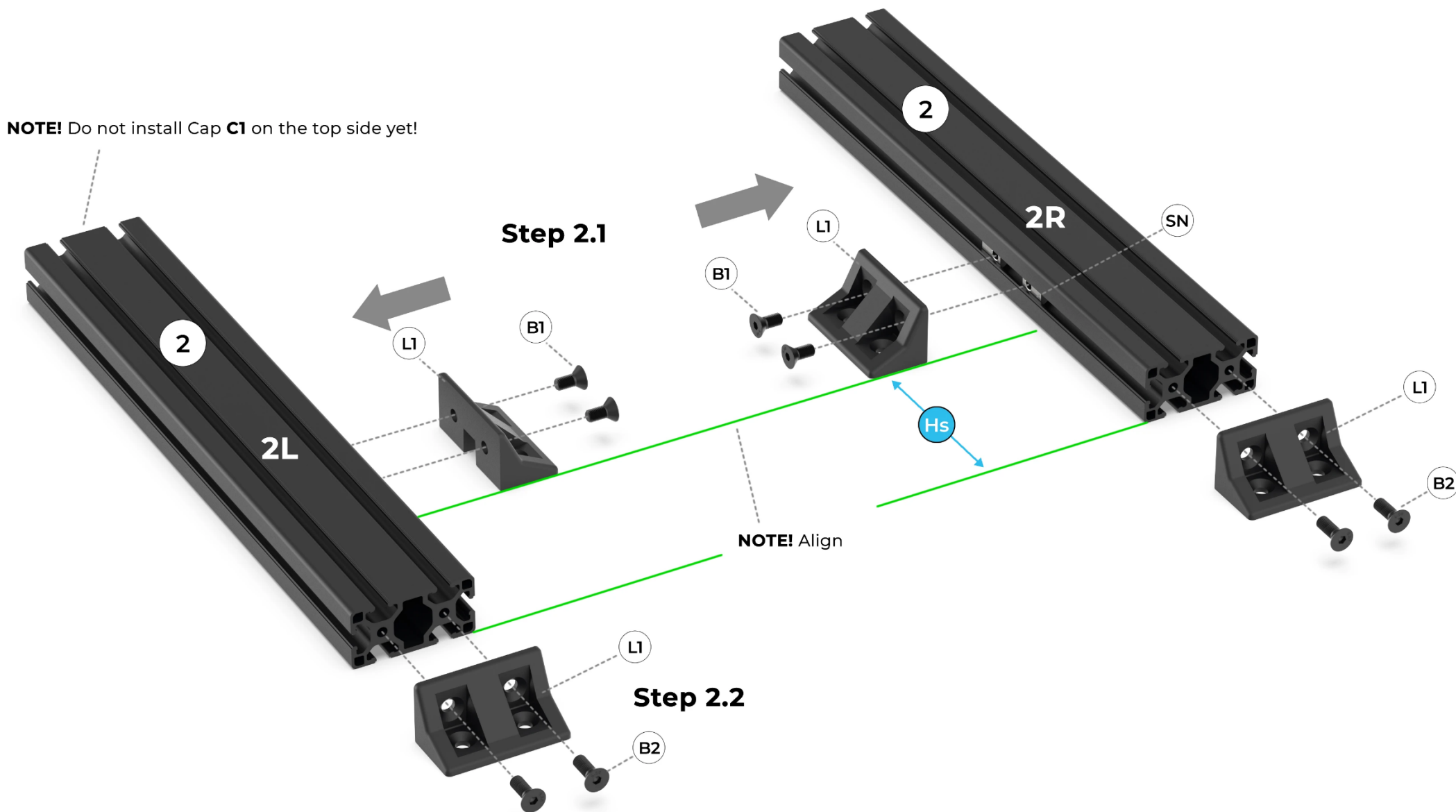

**Step 3A** (Install to AI GT Chassis) Install assemblies **2L** and **2R** to chassis. Use 4 x **B1** - M8 x 16 Countersunk and 4 x **SN** T-Slot nuts per assembly. Use **No.5 Hex Key**.

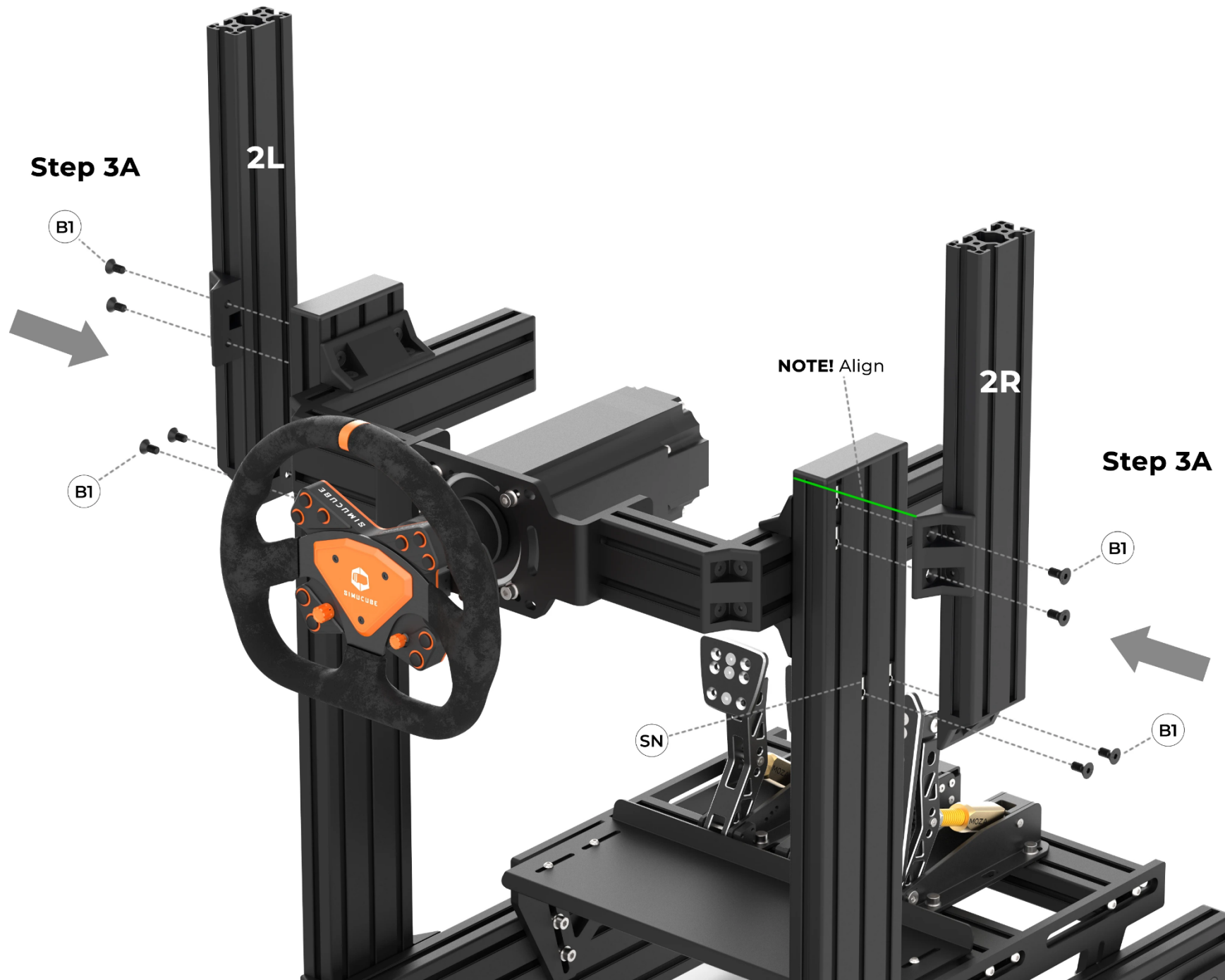

**Step 3B** (Install to A1-120 Formula / A1-160 Formula Chassis) Install assemblies **2L** and **2R** to chassis. Use 4 x **B1** - M8 x 16 Countersunk and 4 x **SN** T-Slot Nuts per assembly. Use **No.5 Hex Key**.

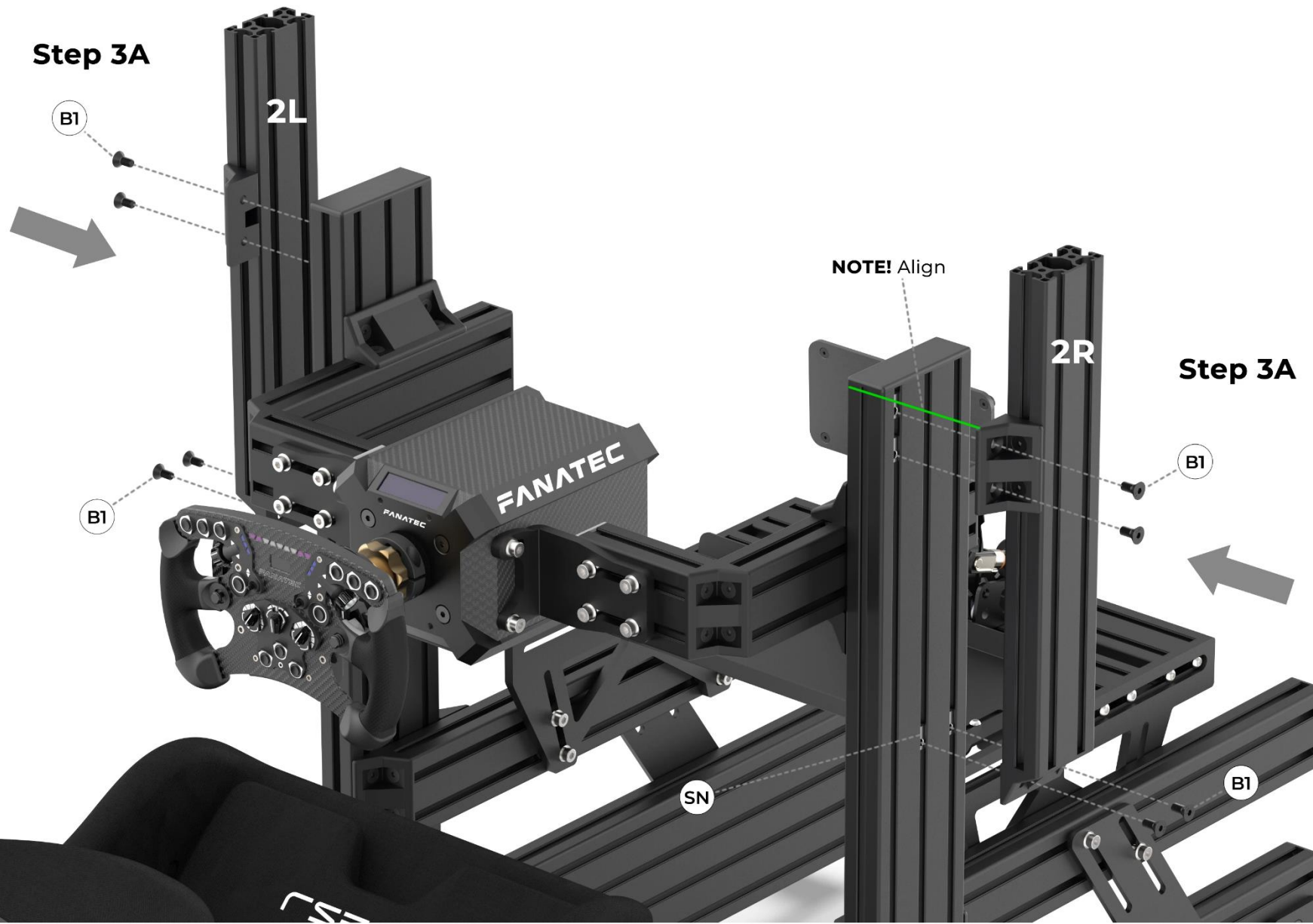



**Step 4A** (Install to AI GT Chassis) Slide assembly **1L** to **2L** and **1R** to **2R**. Align **SN** nuts to be parallel to the T-Slot channels. Align both assemblies **1L** and **1R** at same height and tight **B1** Fasteners using **No.5 Hex Key**. Install 1 x **C1** Plastic cap to **2L** and **2R** assemblies top end. Press by hand.



**Step 4B** (Install to AI-120 Formula / AI-160 Formula Chassis) Slide assembly **1L** to **2L** and **1R** to **2R**. Align **SN** nuts to be parallel to the T-Slot channels. Align both assemblies **1L** and **1R** at same height and tight **B1** Fasteners using **No.5 Hex Key**. Install 1 x **C1** Plastic cap to **2L** and **2R** assemblies top end. Press by hand.

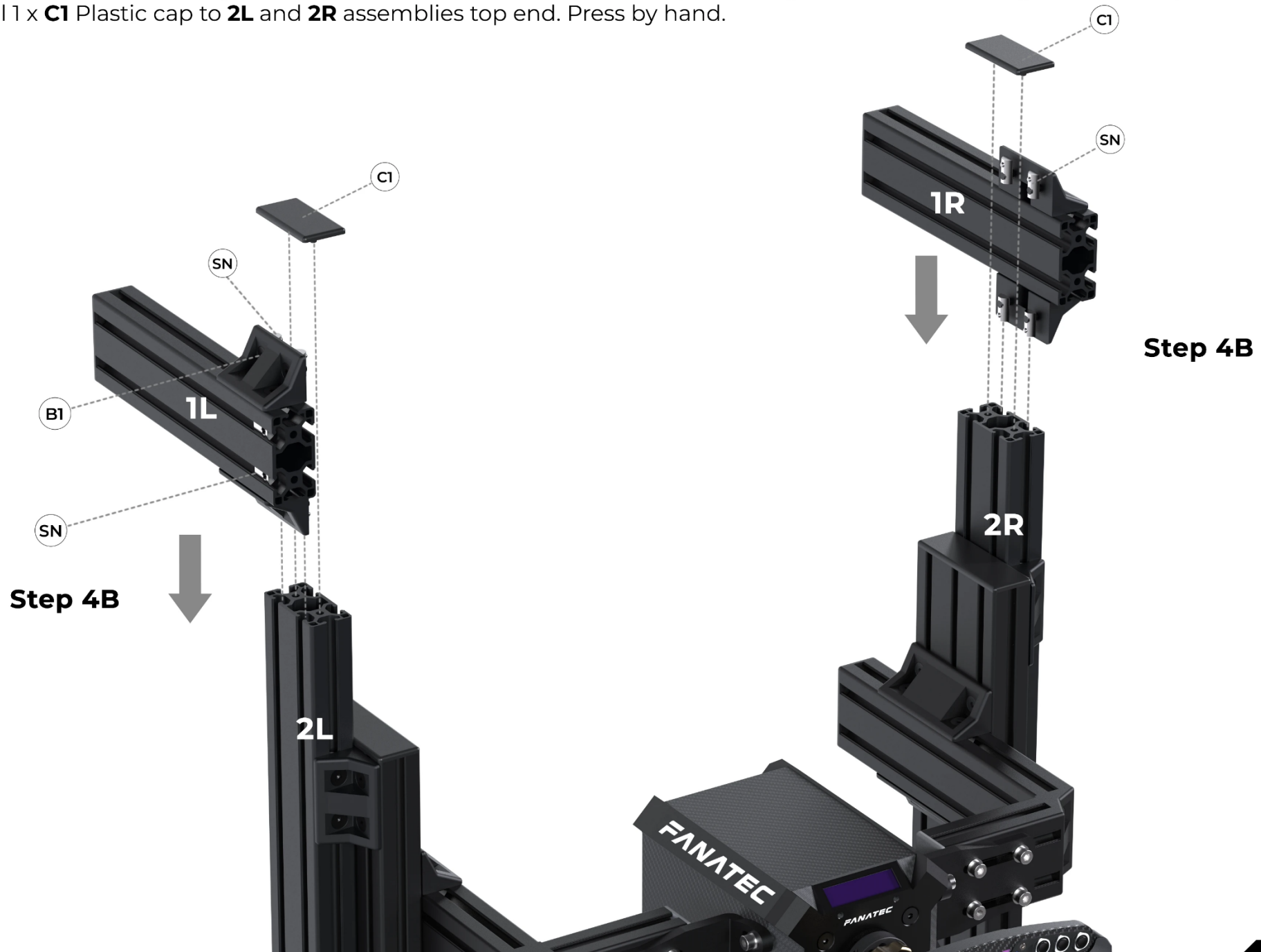

**Step 5.1** Install 2 x **L1** Brackets to Profile **3**. Use 4 x **B1** - M8 x 16 Countersunk and 4 x **SN** T-Slot Nuts. Use **No.5 Hex Key**.

**Step 5.2** Install 2 x **C1** Plastic cap to both ends of profile **3**. Press by hand.

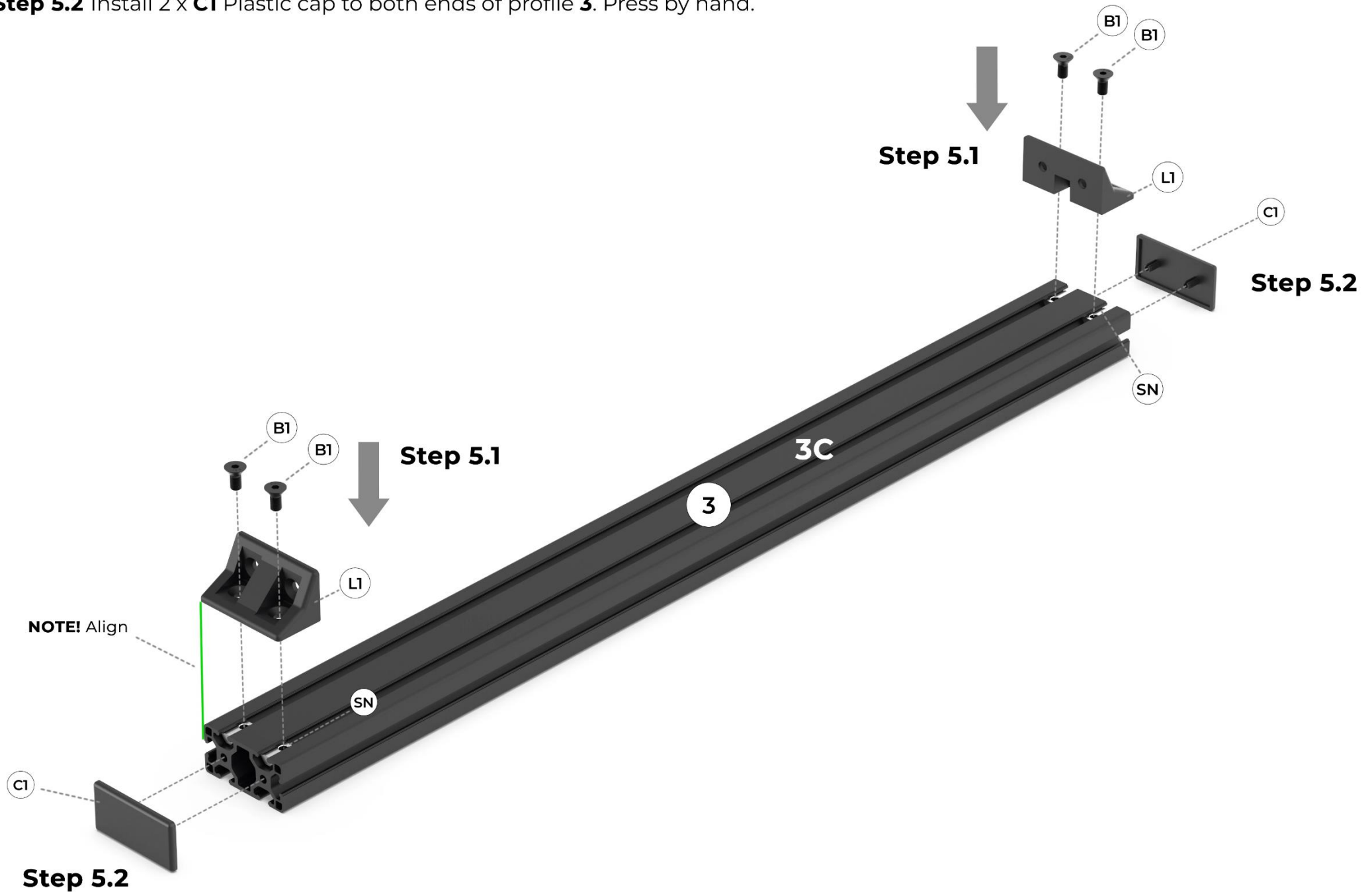



**Step 6A** Install assembly **3C** to assemblies **1L** and **1R**. Use 4 x **B1** - M8 x 16 Countersunk. Use **No.5 Hex Key**.



**Step 6B** Install assembly **3C** to assemblies **1L** and **1R**. Use 4 x **B1** - M8 x 16 Countersunk. Use **No.5 Hex Key**.



**Step 7** VESA Assembly and setup.

If **VESA** up to **100x100** - Connect **V100** to **VB2** using 4 x **V57** M6x10mm countersunk.

If **VESA** up to **200x200** - Connect **V200** to **VB2** using 4 x **BV7** M6x10mm countersunk.

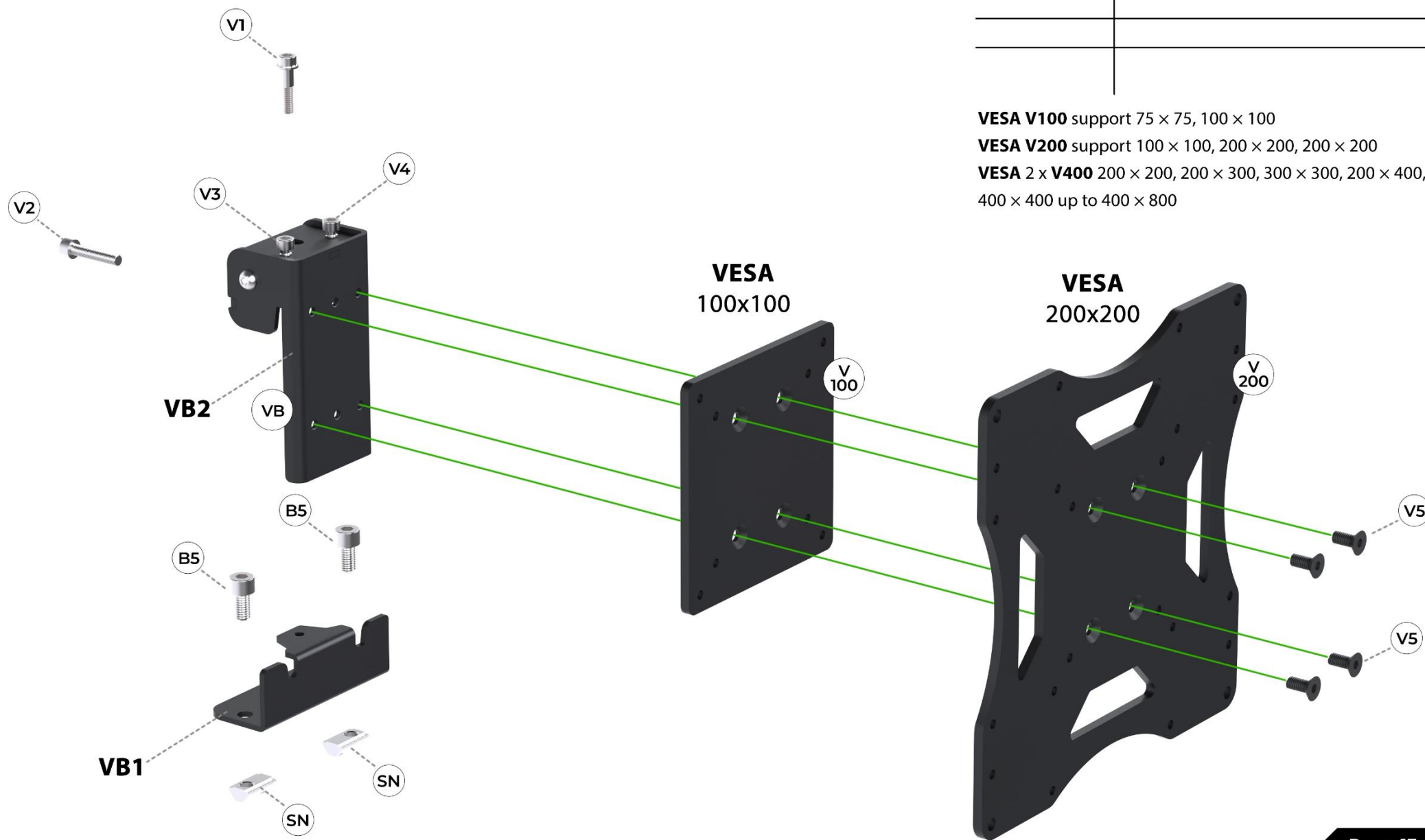

**6 Fasteners and tools**

V1 x 3pcs	M6x25 din 912
V2 x 3pcs	M6x35 din 912
V3, V4 x 6pcs	M8x16 din 912
V5 x 12pcs	M6x10 countersunk

**VESA V100** support 75 × 75, 100 × 100

**VESA V200** support 100 × 100, 200 × 200, 200 × 200

**VESA 2 x V400** 200 × 200, 200 × 300, 300 × 300, 200 × 400, 400 × 400 up to 400 × 800



**Step 8A1** For VESA 100x100 and VESA 200x200 Install **VB1** (VESA Mounting bracket. See step 7) to Assembly **3C**. Use 2 x **B5** - M8 x 16 din 912 and 2 x **SN** T-Slot Nuts. Use **No.6 Hex Key**.

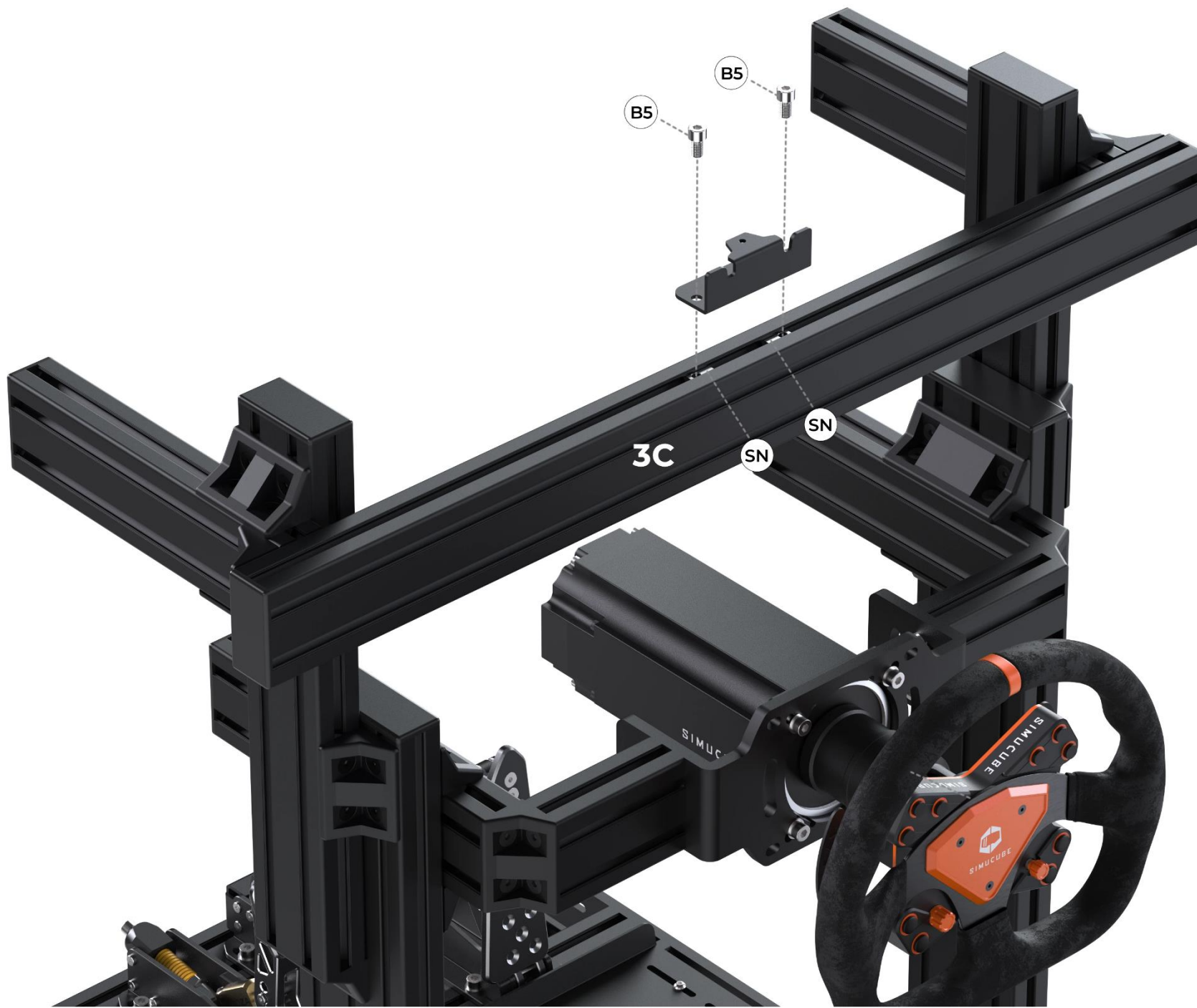

**Step 8B1** For VESA 100x100 and VESA 200x200 Install **VB1** (VESA Mounting bracket. See step 7) to Assembly **3C**. Use 2 x **B5** - M8 x 16 din 912 and 2 x **SN** T-Slot Nuts. Use **No.6 Hex Key**.

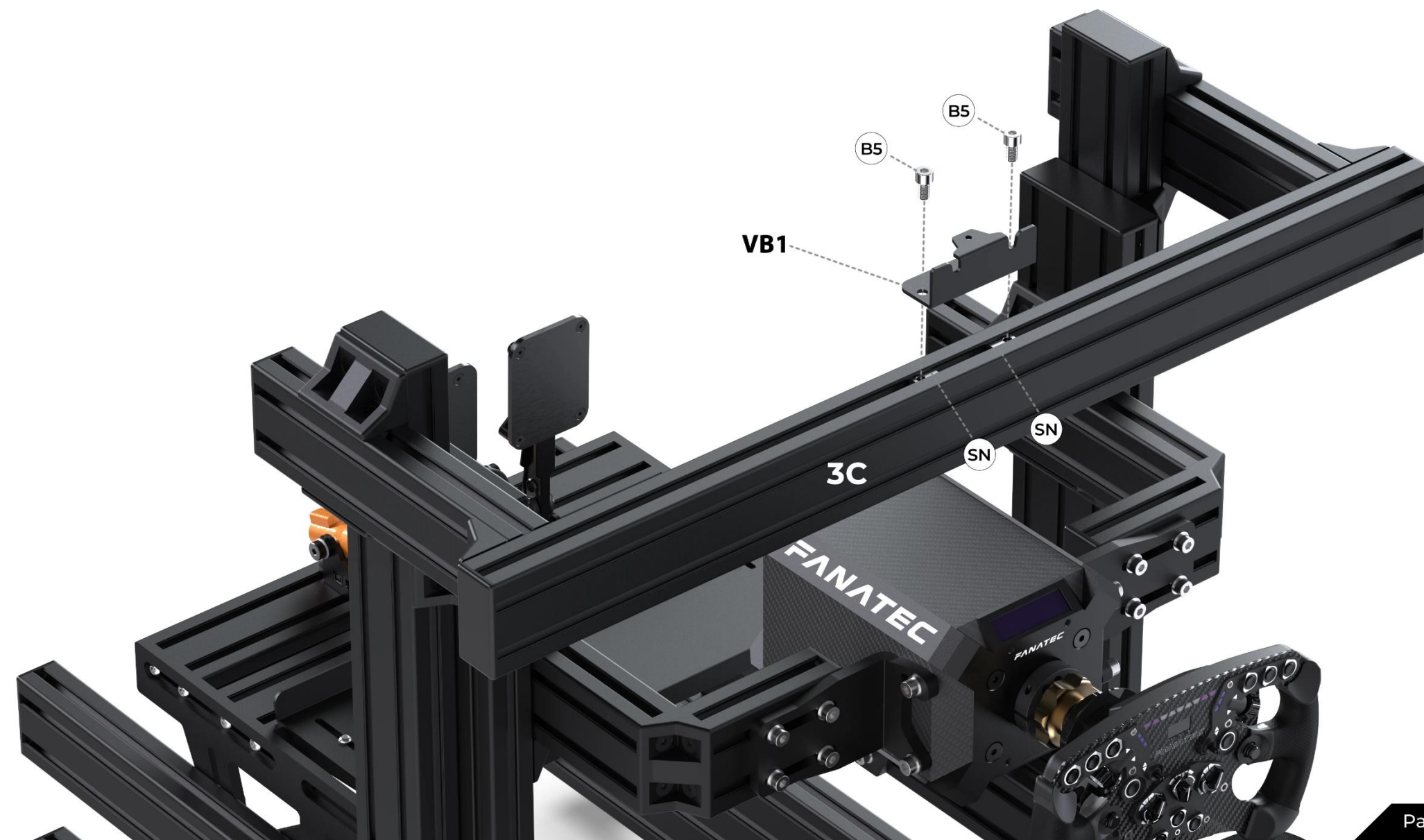

**Step 9.1** Install pair of **U1** Brackets to pair of Profile **2** to form assemblies **AA.L** and **AA.R**. Use 4 x **B8** - M8 x 35 Countersunk. Use **No.5 Hex Key**.

**Step 9.2** Install **VB1** VESA Mounting bracket to Assembly **AA.R** and **AA.L**. Please note the direction. Use 2 x **B5** - M8 x 16 din 912 and 2 x **SN** T-Slot Nuts per assembly. Use **No.6 Hex Key**.

**Step 9.3** Install 2 x **C1** Plastic cap to both ends of profile **3**. Press by hand.

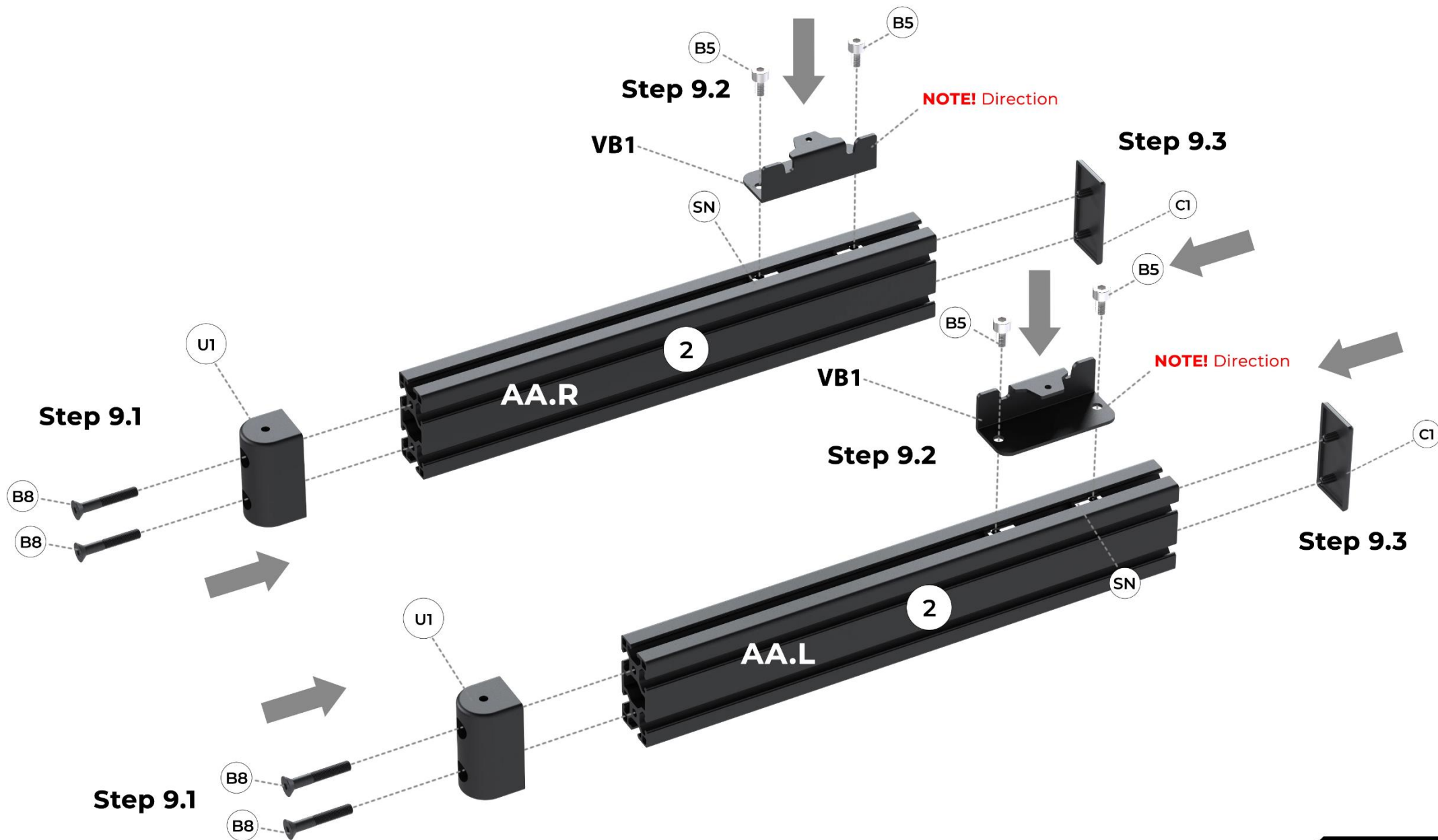



**Step 10A** Install Brackets **2 x HS-L** and **2 x HS-R** to Assembly **3C**. Use 8 x **B1** - M8 x 16 Countersunk and 8 x **SN** T-Slot Nuts. Do not tight the **B1** fasteners yet. Allow to freely move the **HS** brackets left or right on **3C** profile. Use **No.5 Hex Key**.  
**NOTE!** Each **HS** brackets has a specific position on **3C** Assembly.

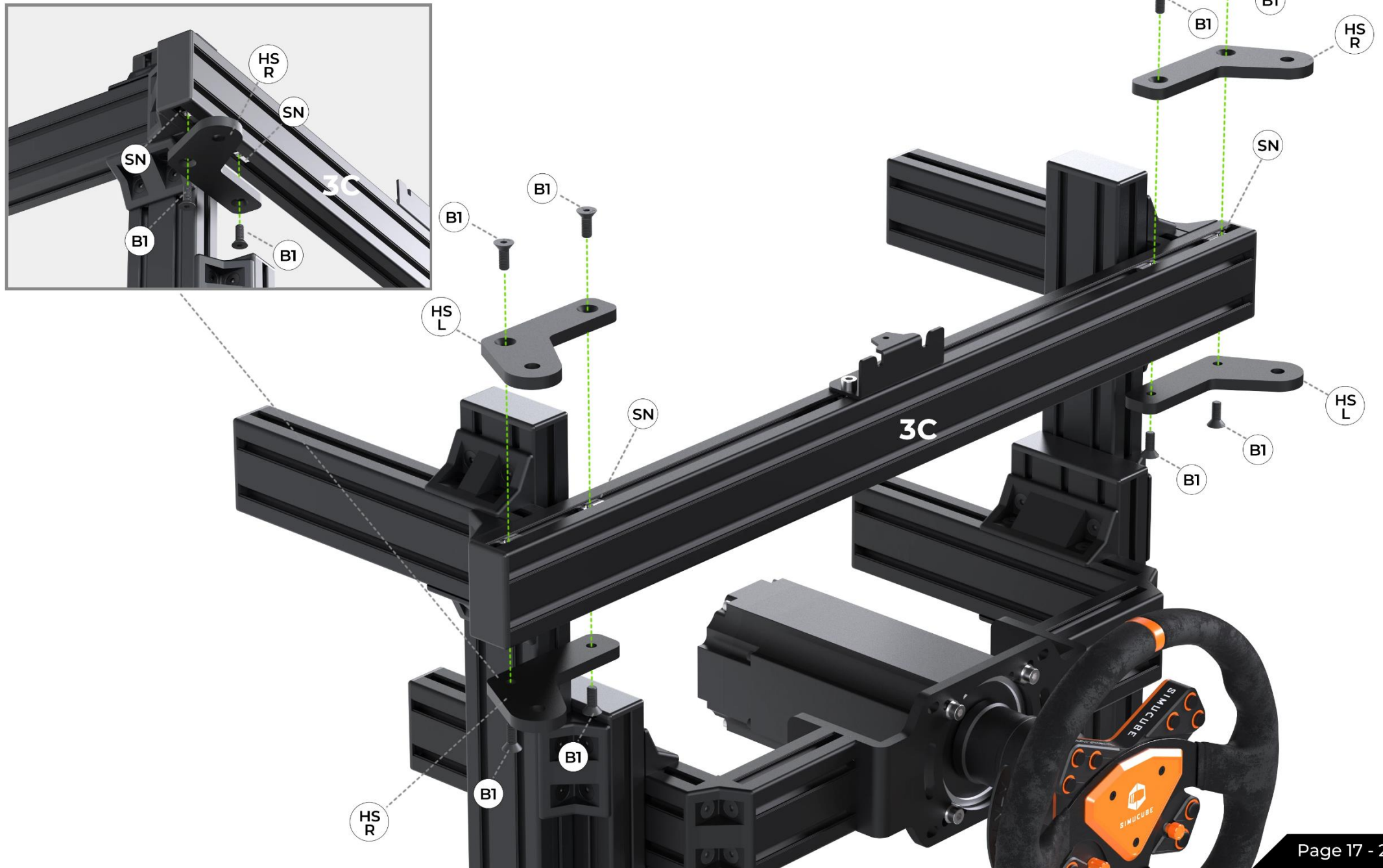



**Step 10B** Install Brackets **2 x HS-L** and **2 x HS-R** to Assembly **3C**. Use 8 x **B1** - M8 x 16 Countersunk and 8 x **SN** T-Slot Nuts. Do not tight the **B1** fasteners yet. Allow to freely move the **HS** brackets left or right on **3C** profile. Use **No.5 Hex Key**.  
**NOTE!** Each **HS** brackets has a specific position on **3C** Assembly.



**Step 11A** Install the left and right articulating arms **AA.L** and **AA.R**. Use 4 x **B9** - M8 x 22 Shoulder bolt and 4 x **S1** - Sleeve. Use **No.5 Hex Key**.



**Step 11B** Install the left and right articulating arms **AA.L** and **AA.R**. Use 4 x **B9** - M8 x 22 Shoulder bolt and 4 x **S1** - Sleeve. Use **No.5 Hex Key**.





**Step 12** Install **V100/VB2** assembly to Monitor with the supported fasteners. In this case, we use the provided 4 x **B24** M4x16 din 912 and VESA 100x100 support. Use **No.3 Hex Key**.

**NOTE!** Do this step for all three Monitors.





**Step 13A.1** Install **VB2** assembly to **VB1** bracket. Slide the monitor down on the **VB1** bracket.

**Step 13A.2** Adjust the horizontal alignment. Set up the horizontal alignment via **V3** and **V4** bolts. Use **No.5 Hex Key**.

**Step 13A.3** Lock the horizontal alignment position with **V1**. Secure the entire assembly with **V2** bolt. Use **No.5 Hex Key**.



**Step 13B.1** Install **VB2** assembly to **VB1** bracket. Slide the monitor down on the **VB1** bracket.

**Step 13B.2** Adjust the horizontal alignment. Set up the horizontal alignment via **V3** and **V4** bolts. Use **No.5 Hex Key**.

**Step 13B.3** Lock the horizontal alignment position with **V1**. Secure the entire assembly with **V2** bolt. Use **No.5 Hex Key**.



- Step 14A.1** Adjust the side monitors position by moving and swing **AA.L** and **AA.R** assemblies. Align all three monitors.
- Step 14A.2** Lock **AA.L** and **AA.R** Horizontal position by **B1** M8 x 16 (top and bottom side on both ends) . Use **No.5 Hex Key**.
- Step 14A.3** Lock **AA.L** and **AA.R** rotation by **B9** M8 x 22 Shoulder bolt . Use **No.5 Hex Key**.





- Step 14B.1** Adjust the side monitors position by moving and swing **AA.L** and **AA.R** assemblies. Align all three monitors.
- Step 14B.2** Lock **AA.L** and **AA.R** Horizontal position by **B1** M8 x 16 (top and bottom side on both ends) . Use **No.5 Hex Key**.
- Step 14B.3** Lock **AA.L** and **AA.R** rotation by **B9** M8 x 22 Shoulder bolt . Use **No.5 Hex Key**.

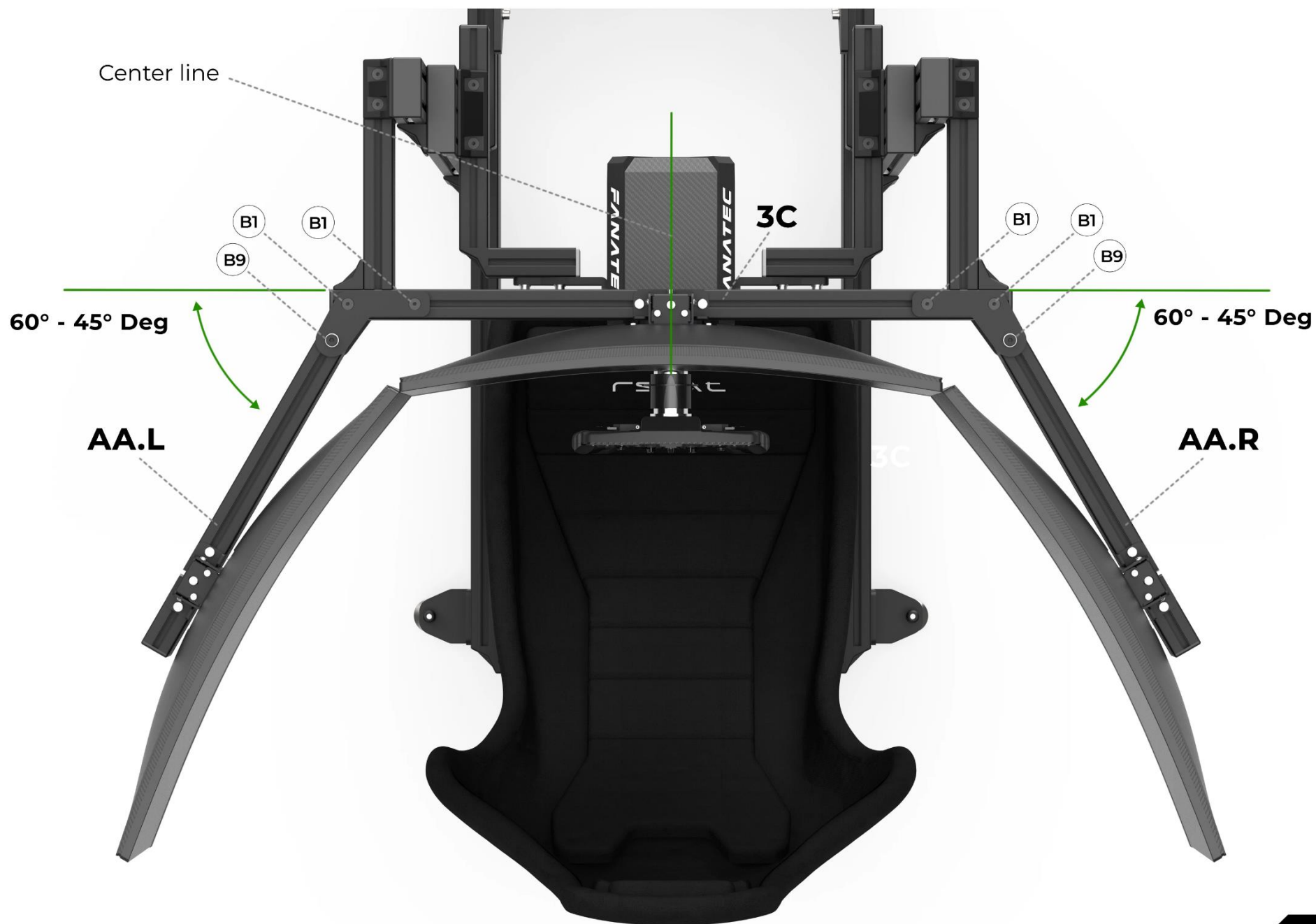



Your **AI-TX32** (GT Setup) Monitor stand is ready!  
Thank you for choosing us!

If you still need help, contact us at  
<https://rseat.net/contact-us/> or by Live Chat



Your **AI-TX32** (Formula Setup) Monitor stand is ready!  
Thank you for choosing us!

If you still need help, contact us at  
<https://rseat.net/contact-us/> or by Live Chat

